

# OneInch Non Electric Water Softener

## INSTALLATION AND OPERATION INSTRUCTIONS

### Before you proceed

**Water hardness.** Before you proceed you must be sure the softener is capable of providing enough softened water for your needs. This is done by checking the hardness of the water in your home and following the recommendations below.

**Call your local water supply company and they will advise the water hardness in your area, look up water in your telephone book.**

Remove the cover from the softener and note the model (service) number on the label.

Given your model, check the hardness of the water is less than hardness given in the chart below.

You may need to adjust the salt setting, it has been shipped to you set on 900. Instructions on how to adjust the salt setting are given on page 3.

Maximum water hardness mg/l

Model	600 salt setting	900 salt setting	1300 salt setting
1600	350	430	490
2200	260	325	370
3000	190	235	270
3600	160	200	225

**Water pressure.** This can be tested with a gauge. The ideal daytime water pressure is 2 to 6 bar, but it must not be below 1 bar or above 8 bar.

**If the pressure is above 6 bar we recommend the installation of a pressure reducing valve set at 6 bar, this valve is available from your supplier.**

**Drinking water.** We advise that a drinking water tap is installed. Your supplier can provide you with an easy to install drinking water tap kit.

**Important: Softened water should not be used for baby food or drinks, also people on a low sodium diet should not drink softened water.**

**Packaging.** Remove the softener and salt tank carefully from the packaging, lift off the cover from the top of the softener and remove the packaging from the inside the cover and cabinet.

### Find a place for your softener.

The softener should ideally be local to the water supply for the whole house and a drain. The salt tank should be sited not more than 3m away from the softener, as governed by the brine tube between the softener and the salt tank. It should be next to an outside wall for the overflow and be easily accessible for filling with salt.

**The salt tank can be positioned above the softener but never below.**

### Pipe size.

The softener is supplied with ¾” and 1” inlet and outlet connections. Select and fit the size connections appropriate to the connecting pipework.

Install the softener as per the plumbing section.

**Note : ½” hoses and bypass kit are suitable for homes with a cold water storage tank, if however your home has a combination or direct hot water system we recommend you install the softener using the high flow hoses and bypass kit.**

**Also, if your water supply pipe is 22mm or larger, install the softener using the high flow hoses and bypass kit.**

Your supplier can provide you with a suitable bypass kit and hoses.

## Plumbing.

1. Turn off the mains water supply to the house by closing the stopcock. Then drain the pipe by opening the kitchen tap.
2. Cut the pipe after the stopcock and install the inlet, outlet and bypass valves. To comply with regulations a check valve must be installed between the stopcock and the softener.

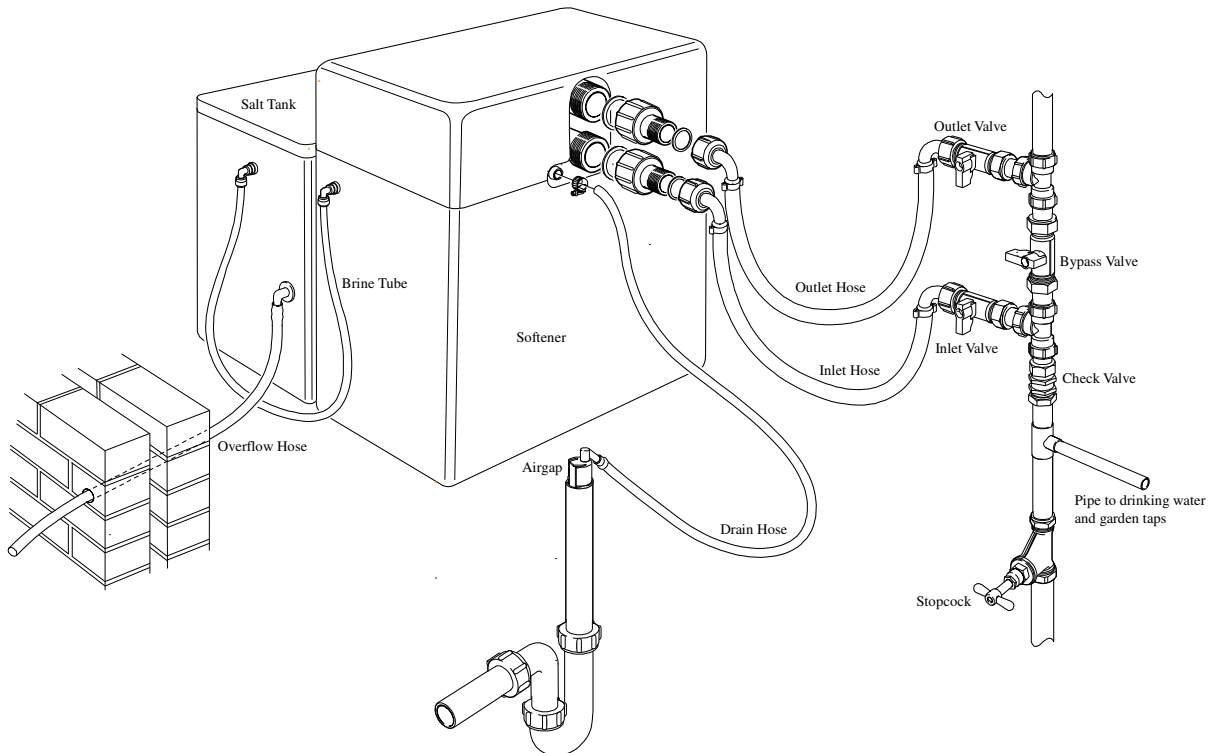

3. The inlet/outlet unions are fixed to the inlet and outlet ports with the large nut and sealed with flat rubber seal. **DO NOT OVER-TIGHTEN THE NUT.**
4. Connect a hose between the softener inlet and the inlet valve, then, connect a hose between the softener outlet and the outlet valve.
5. Turn off the inlet, outlet and bypass valves.
6. The drinking water tap connection and the garden tap connection should be made in the pipe between the stopcock and the bypass valve.
7. Run the drain hose to the nearest waste pipe, typically a washing machine type standpipe. Cut off the excess hose, this is used for the overflow pipe. Install an air gap to the standpipe and connect the drain pipe to the air gap.
8. From the brine tank, push the overflow hose on to the overflow connection on the side of the cabinet and run it downhill to the outside of the house, keep the hose as short as possible.
9. Connect the brine tube between the softener and the brine tank. Shorten the tube to suit. Push the tube ends into the elbow connectors on the softener and salt tank.

## Salt Setting.

The softener has been shipped to you set on 900. If you do need to reset this simply remove the bung. Then undo the thumb nut, holding the screw from the inside. Move the screw and the tube it secures to either the 600 or 1300 hole. Hand tighten the thumb nut on the screw and replace the bung.

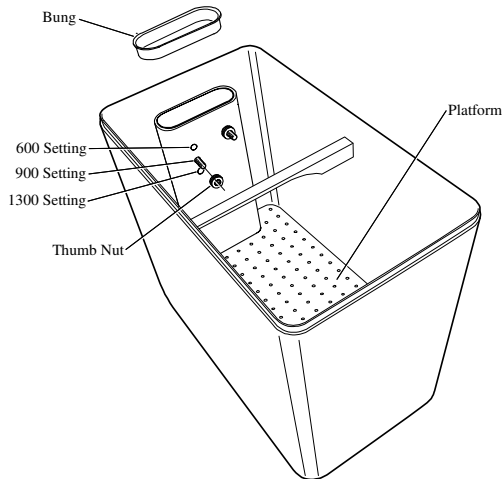

Now manually regenerate the softener by inserting a bladed screw driver into the white button under the cover and depress. Rotate slowly one complete turn clockwise, adjusting the position until the button pops back up.

**Make sure the white button pops back up into the D.**

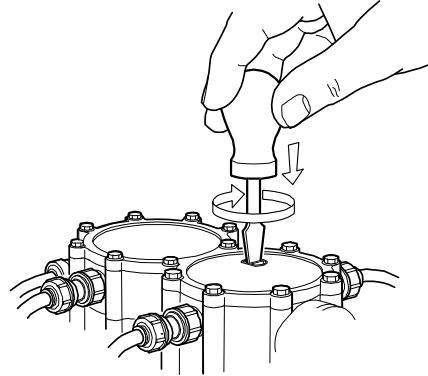

Water will now go down the drain for about 15 minutes removing the water from above the platform in the cabinet. Then the cabinet will refill above the platform.

## Setting to work.

**Fill the cabinet with water to just above the platform using a bowl.**

Open the mains stop cock then the inlet, outlet and bypass valves. Open the kitchen sink tap for a few minutes to remove all the air and any colour from the water, and then close the kitchen tap, bypass and outlet valves. Leave for 10 minutes, checking for leaks.

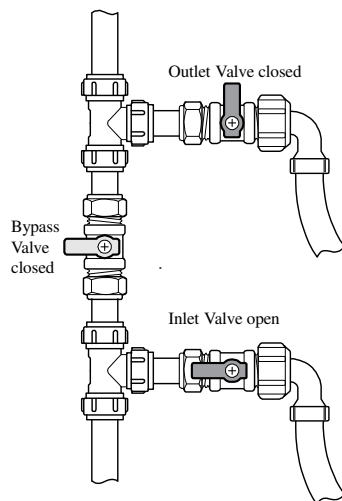

**Open the outlet valve. The inlet, outlet and bypass valves should now look like this.**

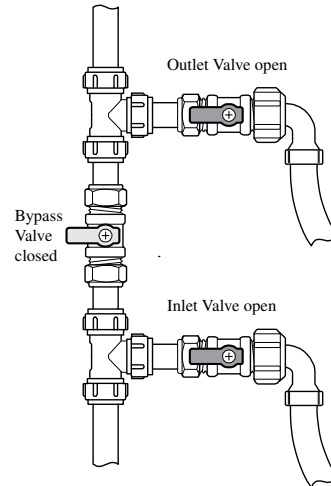

The softener will now start softening the water. Taps directly connected to the softener will give softened water immediately. It will take a while for softened water to fill your storage tank and work its way through your hot water system. You should have partially soft water in a few days and completely soft water in a week or so.

**Filling with salt.**

This softener is designed to use tablet salt. Fill the bin with **tablet salt** as shown.

**NOTE : YOU CAN USE BLOCK SALT BUT IT WILL INCREASE THE AMOUNT OF SALT USED**

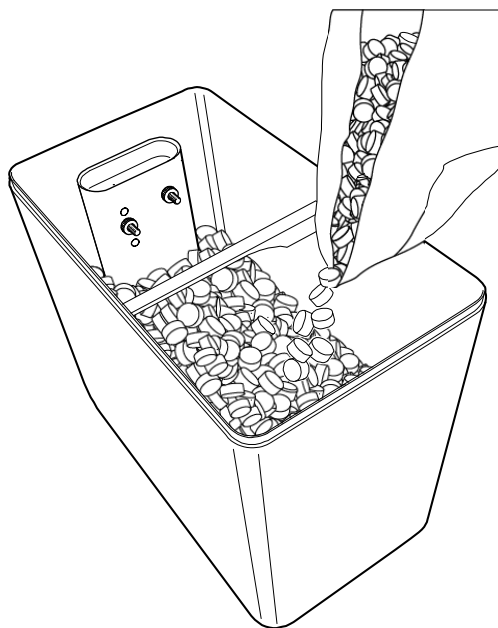

**DO NOT USE FINE OR GRANULAR SALT AS THIS WILL CAUSE A MALFUNCTION**

**Operation.**

**Checking salt.** Regularly check there is salt in the salt compartment. If it is getting low, top up with salt.

**Turn off the softener.** If you ever want to turn off the softener you must, close the inlet and outlet valves, and open the bypass valve.

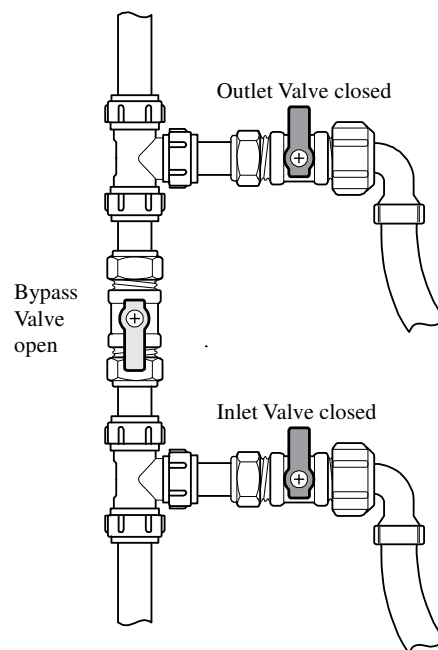

**The softener will no longer operate.**

**Turn on the softener.** To start the softener operating again follow the instructions under **Setting to work.**